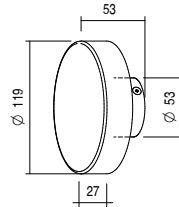
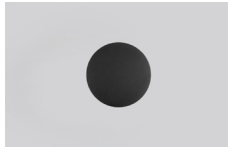

NEW DRIADE APPLIQUE S 230V_{ac}IP65 IK07 CE  | A > A+ > A++TIPOLOGIA / *TPOLOGY*

Applique

POSIZIONE INSTALLATIVA | *INSTALLATION POSITION*A parete | *Wall mounting*AMBIENTE INSTALLATIVO | *INSTALLATION LOCATION*Esterno | *Outdoor*

DRIADE APPLIQUE S

9W

 kg 0,6

CARATTERISTICHE ELETTRICHE | ELECTRICAL FEATURES

POTENZA ASSORBITA POWER CONSUMPTION	9W
ALIMENTAZIONE POWER SUPPLY	230Vac
FREQUENZA FREQUENCY	50/60 Hz
ALIMENTATORE POWER SUPPLY UNIT	Integrato (con elettronica 230Vac) Integrated (with 230Vac electronic)
COLLEGAMENTO CONNECTION	Tensione di rete Mains voltage

CARATTERISTICHE ILLUMINOTECNICHE | LIGHTING FEATURES

COLORE LED LED COLOUR	2700K, 3000K, 4000K
INDICE RESA CROMATICA CRI CRI	>80 (2700K, 3000K, 4000K)
BINNING	3 step MacAdam 3 MacAdam steps
OTTICHE OPTICS	Diffused
FLUSSO REALE EMESSO - 3000K REAL OUTPUT FLUX	9W 896lm
DURATA MEDIA LED AVERAGE LED LIFE	50.000h L80 B10

CARATTERISTICHE MECCANICHE | MECHANICAL FEATURES

PESO WEIGHT	kg 0,6
FINITURE FINISHES	Bianco txt, Nero txt, Corten, Antracite txt, Verde, Sand, Bronzo anodico opaco txt White, txt Black, Corten, txt Anthracite, Green, Sand, Anodic bronze matt
INSTALLAZIONE INSTALLATION	A parete con basetta di fissaggio e viti (incluse) Wall mounting with mounted base and set screws (included)
MATERIALE MATERIAL	Corpo in alluminio anticorrosione verniciato, diffusore in PMMA satinato Varnished anticorrosion aluminium body, satinized PMMA diffuser

CARATTERISTICHE GENERALI | GENERAL FEATURES

TEMPERATURA DI ESERCIZIO OPERATING TEMPERATURE	-10°C +45°C
GRADO DI PROTEZIONE INGRESS PROTECTION	IP65
GRADO DI RESISTENZA IMPACT RESISTANCE	IK07
GLOW WIRE TEST GLOW WIRE TEST	960°C.
TEMPERATURA SCHERMO SCREEN TEMPERATURE	40° @ Ta = 25°
CLASSE DI ISOLAMENTO APPLIANCE CLASS	I
CALPESTABILE WALKOVER	No
CARRABILE DRIVE OVER	No
SICUREZZA STANDARD STANDARD SAFETY	/
SICUREZZA FOTOBIOLOGICA PHOTOBIOLOGICAL SAFETY	GR1