

## ALTEA RECESSED R 24Vdc

IP67 IK08 CE III WP 

TIPOLOGIA / TYPOLOGY

Incasso | Recessed

POSIZIONE INSTALLATIVA | INSTALLATION POSITION

A terra, a parete o a soffitto | Floor, wall or ceiling mounting

AMBIENTE INSTALLATIVO | INSTALLATION LOCATION

Esterno | Outdoor

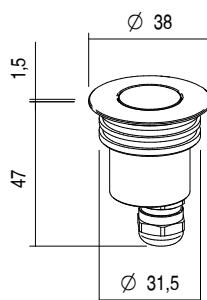

ALTEA RECESSED R

2,2W

Finish .01  
kg 0,13

32 mm

Finish .06 .10  
kg 0,15

## ALTEA RECESSED R 24Vdc

## CARATTERISTICHE ELETTRICHE | ELECTRICAL FEATURES

POTENZA ASSORBITA   POWER CONSUMPTION	2,2W
ALIMENTAZIONE   POWER SUPPLY	24Vdc
ALIMENTATORE   POWER SUPPLY UNIT	2,2W - 24Vdc non incluso   not included
COLLEGAMENTO   CONNECTION	Parallelo   Parallel

## CARATTERISTICHE ILLUMINOTECNICHE | LIGHTING FEATURES

COLORE LED   LED COLOUR	2200K, 2700K, 3000K, 4000K, Red, Green, Blue
INDICE RESA CROMATICA CRI   CRI	>80 (2200K, 2700K, 3000K, 4000K)
BINNING	3 step MacAdam   3 MacAdam steps
OTTICHE   OPTICS	15°, 28°, 64°, 16°x 48°
UGR	<19
FLUSSO REALE EMESSO - 3000K REAL OUTPUT FLUX	2,2W 128lm 28°
DURATA MEDIA LED   AVERAGE LED LIFE	50.000h L80 B10

## CARATTERISTICHE MECCANICHE | MECHANICAL FEATURES

PESO   WEIGHT	Finishing .01	Kg 0,13
	Finishing .06 .10	Kg 0,15
FINITURE   FINISHES	Alluminio anodizzato, Acciaio, Acciaio Spazzolato Anodized aluminium, Steel, Brushed Steel	
INSTALLAZIONE   INSTALLATION	A incasso a terra con cassafornia (non inclusa), a incasso su cartongesso o legno tramite molla (non inclusa), a incasso muratura con cassafornia (non inclusa) Recessed on ground with housing box (not included), recessed on plasterboard or wood with spring (not included), recessed on brickwork with housing box (not included)	
MATERIALE   MATERIAL	Corpo in alluminio anticorrosivo anodizzato, ghiera in alluminio anodizzato o in acciaio inox AISI 316L, vetro temperato trasparente e lente in PMMA Anticorrosive anodized aluminium body, anodized aluminium or AISI 316L stainless steel trim, transparent tempered glass and PMMA lens	

## CARATTERISTICHE GENERALI | GENERAL FEATURES

TEMPERATURA DI ESERCIZIO OPERATING TEMPERATURE	-10°C +45°C
GRADO DI PROTEZIONE   INGRESS PROTECTION	IP67
GRADO DI RESISTENZA   IMPACT RESISTANCE	IK08
GLOW WIRE TEST   GLOW WIRE TEST	960°C
TEMPERATURA MASSIMA APPARECCHIO MAX. TEMPERATURE OF FIXTURE	45° @ Ta = 25°
CLASSE DI ISOLAMENTO   APPLIANCE CLASS	III
CALPESTABILE   WALKOVER	Sì / Yes
CARRABILE   DRIVE OVER	2000 Kg
SICUREZZA STANDARD   STANDARD SAFETY	WP System
SICUREZZA FOTOBIOLOGICA PHOTOBIOLOGICAL SAFETY	GR1

# ALTEA RECESSED R 24Vdc

**ACCESSORI | ACCESSORIES**

<b>CODICE / CODE</b>	<b>ML032</b>
<b>TIPOLOGIA / TYPOLOGY</b>	<b>Molla di torsione</b> <i>Torsion spring</i>  kg 0,001
<b>MATERIALE   MATERIAL</b>	<b>Acciaio inox</b> <i>Stainless steel</i>

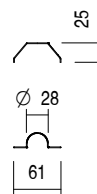

<b>CODICE / CODE</b>	<b>CAW32</b>
<b>TIPOLOGIA / TYPOLOGY</b>	<b>Cassaforma</b> <i>Housing box</i>  kg 0,09
<b>MATERIALE   MATERIAL</b>	<b>PVC</b>

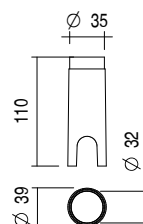

<b>CODICE / CODE</b>	<b>CAI32</b>
<b>TIPOLOGIA / TYPOLOGY</b>	<b>Cassaforma</b> <i>Housing box</i>  kg 0,06
<b>MATERIALE   MATERIAL</b>	<b>ABS</b>

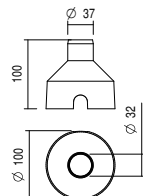

a scelta | to be chosen

**FILTRI | FILTER**

<b>CODICE / CODE</b>	<b>HC</b>
<b>TIPOLOGIA / TYPOLOGY</b>	<b>Filtro Honeycomb</b> <i>Honeycomb filter</i>
<b>CODICE / CODE</b>	<b>BC</b>
<b>TIPOLOGIA / TYPOLOGY</b>	<b>Filtro Black &amp; Clear</b> <i>Black &amp; Clear filter</i>
<b>NOTE</b>	<i>with 15°, 28°, 64° lens only</i>

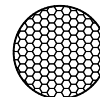

a scelta | to be chosen