

UPDATE

## RIVER C.C.

IP68 IK08 CE III WP SUB 

TIPOLOGIA / TYPOLOGY

Incasso | Recessed

POSIZIONE INSTALLATIVA | INSTALLATION POSITION

A terra, a parete, a immersione | Floor, wall, by immersion mounting

AMBIENTE INSTALLATIVO | INSTALLATION LOCATION

Esterno | Outdoor

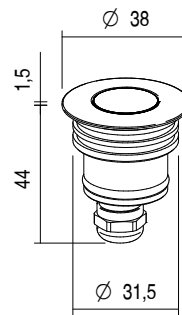

RIVER

1W - 1,6W - 2,5W

 kg 0,55

**CARATTERISTICHE ELETTRICHE | ELECTRICAL FEATURES**

POTENZA ASSORBITA   POWER CONSUMPTION	1W - 1,6W - 2,5W
ALIMENTAZIONE   POWER SUPPLY	C.C.
ALIMENTATORE   POWER SUPPLY UNIT	1W - 350mA Non incluso   Not included 1,6W - 500mA Non incluso   Not included 2,5W - 700mA Non incluso   Not included
COLLEGAMENTO   CONNECTION	Serie   Series

**CARATTERISTICHE ILLUMINOTECNICHE | LIGHTING FEATURES**

COLORE LED   LED COLOUR	2200K, 2700K, 3000K, 4000K, Red, Green, Blue
INDICE RESA CROMATICA CRI   CRI	>80 (2200K, 2700K, 3000K, 4000K)
BINNING	3 step MacAdam   3 MacAdam steps
OTTICHE   OPTICS	10°, 36°, 60°, Diffused, 10° x 55°
FLUSSO REALE EMESSO - 3000K REAL OUTPUT FLUX	1W 89lm 36° - 1,6W 127lm 36° - 2,5W 178lm 36°
DURATA MEDIA LED   AVERAGE LED LIFE	50.000h L80 B10

**CARATTERISTICHE MECCANICHE | MECHANICAL FEATURES**

PESO   WEIGHT	kg 0,55
FINITURE   FINISHES	Acciaio Steel
INSTALLAZIONE   INSTALLATION	A incasso a terra con cassaforma (non inclusa), a incasso su muratura con cassaforma (non inclusa), installazione fuori dall'acqua con cassaforma standard, installazione in immersione permanente con cassaforma IP68 Recessed on ground with housing box (not included), recessed on brickwork with housing box (not included), installation out of water with standard housing box, permanent immersion installation with IP68 housing box
MATERIALE   MATERIAL	Corpo in acciaio inox AISI 316L, ghiera in acciaio inox AISI 316L, vetro temperato trasparente e lente in PMMA AISI 316L stainless steel body, AISI 316L stainless steel trim, transparent tempered glass and PMMA lens

**CARATTERISTICHE GENERALI | GENERAL FEATURES**

TEMPERATURA DI ESERCIZIO OPERATING TEMPERATURE	-10°C +45°C
GRADO DI PROTEZIONE   INGRESS PROTECTION	IP68
GRADO DI RESISTENZA   IMPACT RESISTANCE	IK08
GLOW WIRE TEST   GLOW WIRE TEST	960°C
TEMPERATURA SCHERMO SCREEN TEMPERATURE	40° @ Ta = 25°
CLASSE DI ISOLAMENTO   APPLIANCE CLASS	III
CALPESTABILE   WALKOVER	Sì / Yes
CARRABILE   DRIVE OVER	2000 Kg
SICUREZZA STANDARD   STANDARD SAFETY	WP System
SICUREZZA FOTOBIOLOGICA PHOTOBIOLOGICAL SAFETY	GR1

## ACCESSORI | ACCESSORIES

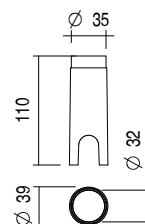

a scelta | to be chosen

<b>CODICE / CODE</b>	<b>CAW32</b>
<b>TIPOLOGIA / TYPOLOGY</b>	<b>Cassaforma</b> Housing box  kg 0,09
<b>MATERIALE   MATERIAL</b>	<b>PVC</b>

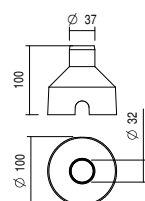

<b>CODICE / CODE</b>	<b>CAI32</b>
<b>TIPOLOGIA / TYPOLOGY</b>	<b>Cassaforma</b> Housing box  kg 0,06
<b>MATERIALE   MATERIAL</b>	<b>ABS</b>



<b>CODICE / CODE</b>	<b>CA832</b>
<b>TIPOLOGIA / TYPOLOGY</b>	<b>Cassaforma IP68</b> IP68 Housing box   kg 0,06
<b>MATERIALE   MATERIAL</b>	<b>PVC</b>

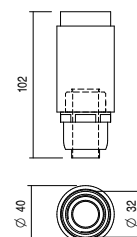

## FILTRI | FILTER

a scelta | to be chosen

<b>CODICE / CODE</b>	<b>HC</b>
<b>TIPOLOGIA / TYPOLOGY</b>	<b>Filtro Honeycomb</b> Honeycomb filter
<b>NOTE</b>	with 10°, 36°, 60°, 10°x 55° lens only

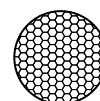

<b>CODICE / CODE</b>	<b>BC</b>
<b>TIPOLOGIA / TYPOLOGY</b>	<b>Filtro Black &amp; Clear</b> Black & Clear filter
<b>NOTE</b>	with 10°, 36°, 60° lens only

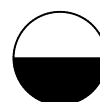

<b>CODICE / CODE</b>	<b>BD</b>
<b>TIPOLOGIA / TYPOLOGY</b>	<b>Filtro Black &amp; Diffused</b> Black & Diffused filter
<b>NOTE</b>	with diffused lens only

