

DEMETRA

IP40 IK06 CE 

TIPOLOGIA / TYPOLOGY

Incasso | Recessed

POSIZIONE INSTALLATIVA | INSTALLATION POSITION A parete, a soffitto | Wall and ceiling mounting

AMBIENTE INSTALLATIVO | INSTALLATION LOCATION Interno | Indoor

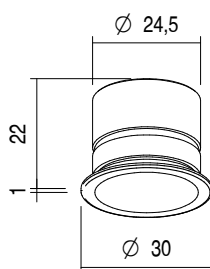

DEMETRA R

1W - 1,6W



kg 0,02



25 mm

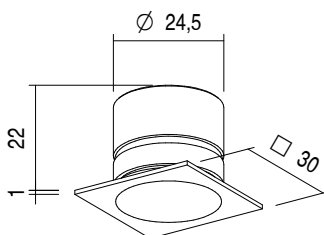

DEMETRA S

1W - 1,6W



kg 0,02



25 mm

DEMETRA

CARATTERISTICHE ELETTRICHE | ELECTRICAL FEATURES

POTENZA ASSORBITA POWER CONSUMPTION	1W - 1,6W
ALIMENTAZIONE POWER SUPPLY	C.C.
ALIMENTATORE POWER SUPPLY UNIT	1W - 350mA non incluso not included 1,6W - 500mA non incluso not included
COLLEGAMENTO CONNECTION	Serie Series

CARATTERISTICHE ILLUMINOTECNICHE | LIGHTING FEATURES

COLORE LED LED COLOUR	2200K, 2700K, 3000K, 4000K, Red, Green, Blue
INDICE RESA CROMATICA CRI CRI	>90 (2700 K, 3000 K, 4000 K)
INDICE RESA CROMATICA CRI CRI	>80 (2200 K)
BINNING	3 step MacAdam 3 MacAdam steps
OTTICHE OPTICS	15°, 28°, 64°
UGR	<19
FLUSSO REALE EMESSO - 3000K REAL OUTPUT FLUX	1W 82lm 28° - 1,6W 116lm 28°
DURATA MEDIA LED AVERAGE LED LIFE	50.000h L80 B10

CARATTERISTICHE MECCANICHE | MECHANICAL FEATURES

PESO WEIGHT	Kg 0,02
FINITURE FINISHES	Bianco txt, Grigio txt, Nero txt, Corten, Sand txt White, txt Grey, txt Black, Corten, Sand
INSTALLAZIONE INSTALLATION	A incasso su cartongesso o legno tramite molla non inclusa, a incasso su muratura con cassaforma non inclusa Recessed on plasterboard or wood with spring not included, recessed on brickwork with housing box not included
MATERIALE MATERIAL	Corpo in alluminio anticorodal, lente in PMMA Anticorodal aluminium body, PMMA lens

CARATTERISTICHE GENERALI | GENERAL FEATURES

TEMPERATURA DI ESERCIZIO OPERATING TEMPERATURE	-10°C +45°C
GRADO DI PROTEZIONE INGRESS PROTECTION	IP40
GRADO DI RESISTENZA IMPACT RESISTANCE	IK06
GLOW WIRE TEST GLOW WIRE TEST	960°C
TEMPERATURA SCHERMO SCREEN TEMPERATURE	40° @ Ta = 25°
CLASSE DI ISOLAMENTO APPLIANCE CLASS	III
CALPESTABILE WALKOVER	No
CARRABILE DRIVE OVER	No
SICUREZZA STANDARD STANDARD SAFETY	I
SICUREZZA FOTOBIOLOGICA PHOTOBIOLOGICAL SAFETY	GR1

DEMETRA

ACCESSORI | ACCESSORIES

CODICE / CODE	ML025	
TIPOLOGIA / TYPOLOGY	Molla di torsione <i>Torsion spring</i>	 kg 0,001
MATERIALE / MATERIAL	Acciaio armonico <i>Harmonic steel</i>	

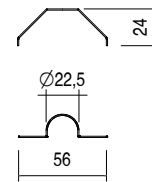

CODICE / CODE	CAS25	
TIPOLOGIA / TYPOLOGY	Cassaforma Housing box	 kg 0,012
MATERIALE / MATERIAL	PVC	

