

## BIA MINI R - SINGLE EM. 24Vdc

IP67 IK10 CE III WP 

TIPOLOGIA / *TPOLOGY*

Incasso | *Recessed*

POSIZIONE INSTALLATIVA | *INSTALLATION POSITION*

A terra, a parete | *Floor, wall*

AMBIENTE INSTALLATIVO | *INSTALLATION LOCATION*

Esterno | *Outdoor*

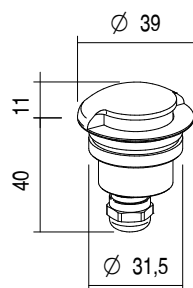
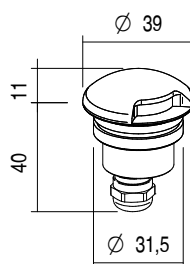

Bia Mini R 180°

### BIA MINI R - SINGLE EM.

**2,2W**



Finish .01  
kg 0,12



32 mm



Finish .06 .10  
kg 0,16

## BIA MINI R - SINGLE EM. 24Vdc

## CARATTERISTICHE ELETTRICHE | ELECTRICAL FEATURES

POTENZA ASSORBITA   POWER CONSUMPTION	2,2W
ALIMENTAZIONE   POWER SUPPLY	24Vdc
ALIMENTATORE   POWER SUPPLY UNIT	2,2W - 24Vdc (Non incluso   Not included)
COLLEGAMENTO   CONNECTION	Parallelo   Parallel

## CARATTERISTICHE ILLUMINOTECNICHE | LIGHTING FEATURES

COLORE LED   LED COLOUR	2200K, 2700K, 3000K, 4000K, Red, Green, Blue
INDICE RESA CROMATICA CRI   CRI	>80 (2200K, 2700K, 3000K, 4000K)
BINNING	3 step MacAdam   3 MacAdam steps
OTTICHE   OPTICS	Mini R version: Radial Mini R 180° version: Radial 180°
FLUSSO REALE EMESSO - 3000K REAL OUTPUT FLUX	Mini R version: 2,2W 21lm Radial Mini R 180° version: 2,2W 32lm Radial 180°
DURATA MEDIA LED   AVERAGE LED LIFE	50.000h L80 B10

## CARATTERISTICHE MECCANICHE | MECHANICAL FEATURES

PESO   WEIGHT	Finishig .01 Kg 0,12 Finishig .06 .10 Kg 0,16
FINITURE   FINISHES	Alluminio anodizzato, Acciaio, Nero txt, Corten, Acciaio Spazzolato, Antracite txt, Sand Anodized aluminium, Steel, txt Black, Corten, Brushed Steel, txt Anthracite, Sand
INSTALLAZIONE   INSTALLATION	A incasso a terra con cassaforma (non inclusa), a incasso su cartongesso o legno tramite molla (non inclusa) Recessed on ground with housing box (not included), recessed on plasterboard or wood with spring (not included)
MATERIALE   MATERIAL	Corpo in alluminio anticorodal, ghiera in alluminio anticorodal o in acciaio inox AISI 316L, ottica in PMMA o PC Anticorodal aluminium body, anticorodal aluminium or AISI 316L stainless steel trim PMMA optics or PC

## CARATTERISTICHE GENERALI | GENERAL FEATURES

TEMPERATURA DI ESERCIZIO OPERATING TEMPERATURE	-10°C +45°C
GRADO DI PROTEZIONE   INGRESS PROTECTION	IP67
GRADO DI RESISTENZA   IMPACT RESISTANCE	IK10
GLOW WIRE TEST   GLOW WIRE TEST	960°C
TEMPERATURA MASSIMA APPARECCHIO MAX. TEMPERATURE OF FIXTURE	45° @ Ta = 25°
CLASSE DI ISOLAMENTO   APPLIANCE CLASS	III
CALPESTABILE   WALKOVER	Sì / Yes
CARRABILE   DRIVE OVER	2000 Kg
SICUREZZA STANDARD   STANDARD SAFETY	WP System
SICUREZZA FOTOBIOLOGICA PHOTOBIOLOGICAL SAFETY	GR1

## BIA MINI R - SINGLE EM. 24Vdc

## ACCESSORI | ACCESSORIES

<b>CODICE / CODE</b>	<b>ML032</b>	
<b>TIPOLOGIA / TYPOLOGY</b>	<b>Molla di torsione</b> <i>Torsion spring</i>	 kg 0,001
<b>MATERIALE   MATERIAL</b>	<b>Acciaio inox</b> <i>Stainless steel</i>	

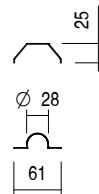

<b>CODICE / CODE</b>	<b>CAW32</b>	
<b>TIPOLOGIA / TYPOLOGY</b>	<b>Cassaforma</b> <i>Housing box</i>	 kg 0,09
<b>MATERIALE   MATERIAL</b>	<b>PVC</b>	

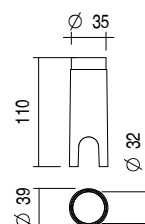

a scelta | to be chosen

<b>CODICE / CODE</b>	<b>CAI32</b>	
<b>TIPOLOGIA / TYPOLOGY</b>	<b>Cassaforma</b> <i>Housing box</i>	 kg 0,06
<b>MATERIALE   MATERIAL</b>	<b>ABS</b>	

