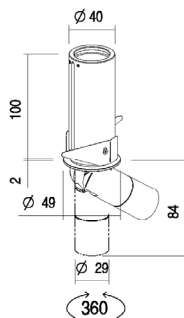

NEW

## GEA FRAME IP40 IN-OUT C.C.

IP40 IK06 CE    |   TIPOLOGIA / *TPOLOGY*Incasso Estraibile | *Recessed*POSIZIONE INSTALLATIVA | *INSTALLATION POSITION*A soffitto | *Ceiling mounting*AMBIENTE INSTALLATIVO | *INSTALLATION LOCATION*Interno | *Indoor*

## GEA FRAME IP40 IN-OUT

6W



kg 0,28



42 mm

## CARATTERISTICHE ELETTRICHE | ELECTRICAL FEATURES

POTENZA ASSORBITA   POWER CONSUMPTION	6W
ALIMENTAZIONE   POWER SUPPLY	C.C.
ALIMENTATORE   POWER SUPPLY UNIT	6W - 500mA Non incluso   Not included
COLLEGAMENTO   CONNECTION	Serie   Series

## CARATTERISTICHE ILLUMINOTECNICHE | LIGHTING FEATURES

COLORE LED   LED COLOUR	2700K, 3000K, 4000K
INDICE RESA CROMATICA CRI   CRI	>90 (2700K, 3000K, 4000K)
BINNING	3 step MacAdam   3 MacAdam steps
OTTICHE   OPTICS	10°, 36°, 60°
UGR	<19
FLUSSO REALE EMESSO - 3000K REAL OUTPUT FLUX	6W 408lm 36°
DURATA MEDIA LED   AVERAGE LED LIFE	50.000h L80 B10

## CARATTERISTICHE MECCANICHE | MECHANICAL FEATURES

PESO   WEIGHT	Kg 0,28
FINITURE   FINISHES	Bianco txt , Grigio txt, Nero txt txt White, txt Grey, txt Black
INSTALLAZIONE   INSTALLATION	A incasso su cartongesso o legno tramite molle (includere) A incasso su muratura con cassaforma (non inclusa) e molla (inclusa) Recessed on plasterboard or wood with springs (included) Recessed on brickwork with housing box (not included) and spring (included)
MATERIALE   MATERIAL	Corpo in alluminio verniciato con cornice, lente in PMMA Varnished aluminium body with frame, PMMA lens

## CARATTERISTICHE GENERALI | GENERAL FEATURES

TEMPERATURA DI ESERCIZIO OPERATING TEMPERATURE	-10°C +45°C
GRADO DI PROTEZIONE   INGRESS PROTECTION	IP40
GRADO DI RESISTENZA   IMPACT RESISTANCE	IK06
GLOW WIRE TEST   GLOW WIRE TEST	960°C
TEMPERATURA SCHERMO SCREEN TEMPERATURE	40° @ Ta = 25°
CLASSE DI ISOLAMENTO   APPLIANCE CLASS	III
CALPESTABILE   WALKOVER	No
CARRABILE   DRIVE OVER	No
SICUREZZA STANDARD   STANDARD SAFETY	I
SICUREZZA FOTOBIOLOGICA PHOTOBIOLOGICAL SAFETY	GR1

NEW

## GEA FRAME IP40 IN-OUT C.C.

## ACCESSORI | ACCESSORIES

<b>CODICE / CODE</b>	<b>CMGI23</b>
<b>TIPOLOGIA / TYPOLOGY</b>	<b>Cassaforma</b> Housing box  kg 2,20
<b>MATERIALE   MATERIAL</b>	<b>Acciaio inox e alluminio</b> Stainless steel and aluminium

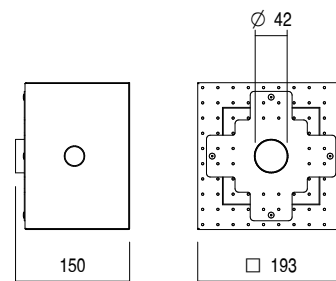

<b>CODICE / CODE</b>	<b>CHGEA</b>
<b>TIPOLOGIA / TYPOLOGY</b>	<b>Estrattore</b> Extractor
<b>MATERIALE   MATERIAL</b>	<b>PLA</b>

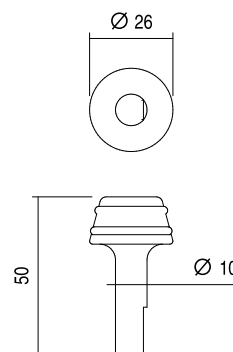

## FILTRI | FILTER

<b>CODICE / CODE</b>	<b>HC</b>
<b>TIPOLOGIA / TYPOLOGY</b>	<b>Filtro Honeycomb</b> Honeycomb filter

